

0.5mm Contact Spacing, ZIF Type Board To FPC Connectors Slide SMT Type

EFC-PT24 SERIES (SU/SD/S)

■ FEATURES

- 0.5mm contact spacing
- No. of contacts: 4~60 pin
- Connector Heights: 2.0 mm
- Accommodated FFC / FPC Thickness: 0.27mm
- Available in tube or embossed type for automatic mounting

■ SPECIFICATIONS

1.ELECTRICAL

- Voltage rating: 50V (per contact)
- Current rating: 0.4A (per contact)
- Dielectric Withstanding Voltage: 250VAC RMS
- Contact resistance: 20mΩ max. (initial), 40mΩ max. (final)
- Insulation resistance: 100MΩ min.
- Operating Temp.: -25°C ~+85°C
- Storage Temp.: -10°C ~+50°C

2.MECHANICAL

- Durability: Mate & Unmate with applicability for 20 times, Contact resistance: 40mΩ max.
- Operating force (Slider): 0.05kgf*n (0.49N*n) max. (n: Pin)
- Cable holding force: 0.1kgf*n (1N*n) min. (n: Pin)
- Contact retention force: 0.3kgf (3N) min.

■ MATERIALS

1.MATERIAL

- Contacts: Copper Alloy
- Hold Down: Copper Alloy
- Insulator Housing: High Temp. Thermoplastic
- Slide: High Temp. Thermoplastic

2.PLATING

Contact:

- Nickel In All Area
- Tin over Nickel (RoHS Compliant)
- Au over Nickel (RoHS Compliant)

Hold Down:

- Tin over Nickel (RoHS Compliant)

■ PACKING

1.Packing method

- All connector are packed in tube or reel method.

2.Information on label (stuck to each ploy bag, reel and box)

- | | | | |
|--------------|------------------|--------------|--------------|
| (1)Part NO. | (2)Section. | (3)Lot NO. | (4)Quantity. |
| (5)QC stamp. | (6)Reprocess NO. | (7)ECE mark. | |

■ PART NUMBERING SYSTEM

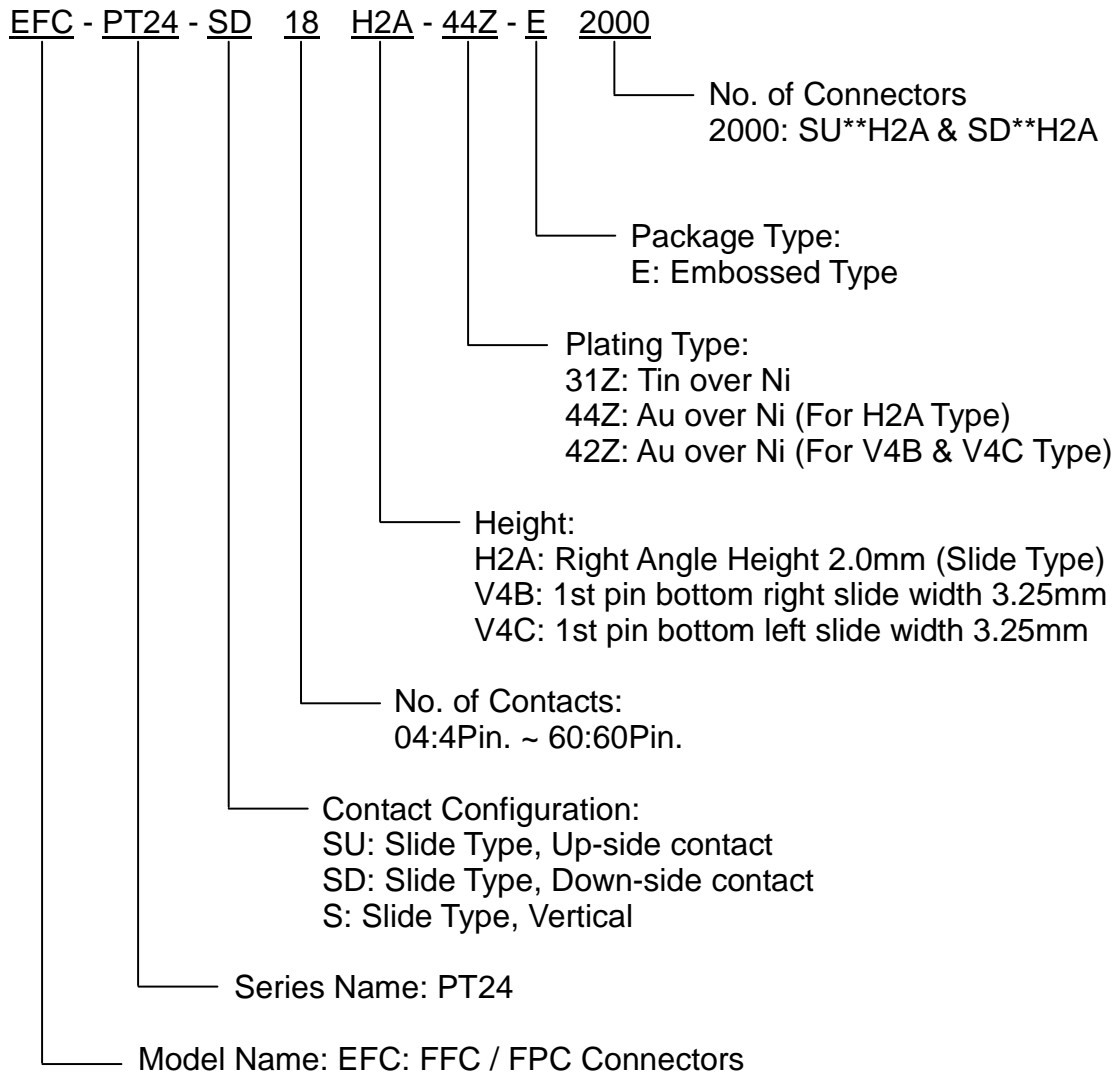

■ DIMENSIONS UNIT:mm

EFC-PT24-SU**H2A



EFC-PT24-SD**H2A



EFC-PT24-S**V4*





EFC-PT24-SU**H2A UNIT:mm

Connection Style: Right Angle Up Side Type

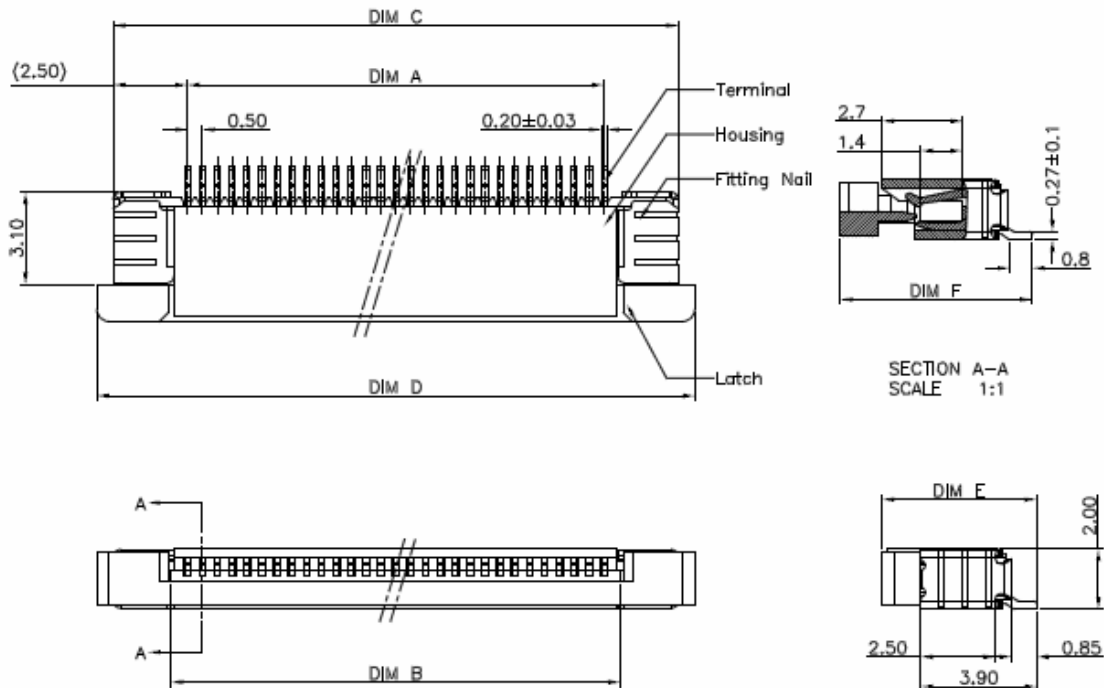

CKTS	DIM A	DIM B	DIM C	DIM D	DIM E	DIM F
4	1.50	2.60	6.50	7.60		
5	2.00	3.10	7.00	8.10		
6	2.50	3.60	7.50	8.60		
7	3.00	4.10	8.00	9.10		
8	3.50	4.60	8.50	9.60		
9	4.00	5.10	9.00	10.10		
10	4.50	5.60	9.50	10.60		
11	5.00	6.10	10.00	11.10		
12	5.50	6.60	10.50	11.60		
13	6.00	7.10	11.00	12.10		
14	6.50	7.60	11.50	12.60		
15	7.00	8.10	12.00	13.10		
16	7.50	8.60	12.50	13.60		
17	8.00	9.10	13.00	14.10		
18	8.50	9.60	13.50	14.60		
19	9.00	10.10	14.00	15.10	5.20	6.45
20	9.50	10.60	14.50	15.60		
21	10.00	11.10	15.00	16.10		
22	10.50	11.60	15.50	16.60		
23	11.00	12.10	16.00	17.10		
24	11.50	12.60	16.50	17.60		
25	12.00	13.10	17.00	18.10		
26	12.50	13.60	17.50	18.60		
27	13.00	14.10	18.00	19.10		
28	13.50	14.60	18.50	19.60		
29	14.00	15.10	19.00	20.10		
30	14.50	15.60	19.50	20.60		
31	15.00	16.10	20.00	21.10		
32	15.50	16.60	20.50	21.60		
33	16.00	17.10	21.00	22.10		
34	16.50	17.60	21.50	22.60		

CKTS	DIM A	DIM B	DIM C	DIM D	DIM E	DIM F
35	17.00	18.10	22.00	23.10		
36	17.50	18.60	22.50	23.60		
37	18.00	19.10	23.00	24.10		
38	18.50	19.60	23.50	24.60		
39	19.00	20.10	24.00	25.10		
40	19.50	20.60	24.50	25.60		
41	20.00	21.10	25.00	26.10		
42	20.50	21.60	25.50	26.60		
43	21.00	22.10	26.00	27.10		
44	21.50	22.60	26.50	27.60		
45	22.00	23.10	27.00	28.10		
46	22.50	23.60	27.50	28.60		
47	23.00	24.10	28.00	29.10	5.75	7.00
48	23.50	24.60	28.50	29.60		
49	24.00	25.10	29.00	30.10		
50	24.50	25.60	29.50	30.60		
51	25.00	26.10	30.00	31.10		
52	25.50	26.60	30.50	31.60		
53	26.00	27.10	31.00	32.10		
54	26.50	27.60	31.50	32.60		
55	27.00	28.10	32.00	33.10		
56	27.50	28.60	32.50	33.60		
57	28.00	29.10	33.00	34.10		
58	28.50	29.60	33.50	34.60		
59	29.00	30.10	34.00	35.10		
60	29.50	30.60	34.50	35.60		

EFC-PT24-SD**H2A UNIT:mm Connection Style: Right Angle Down Side Type

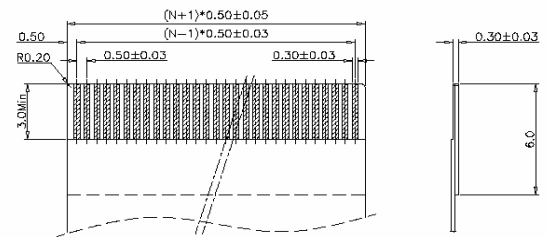
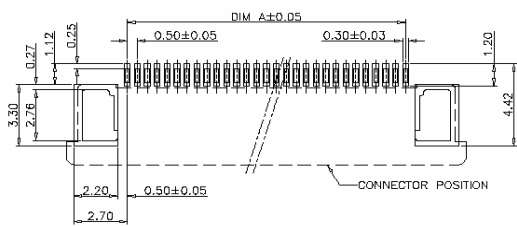
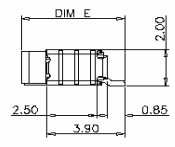
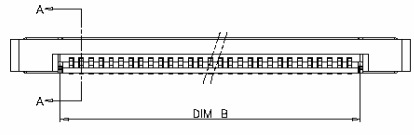
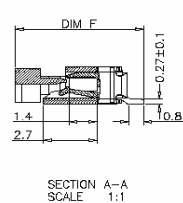
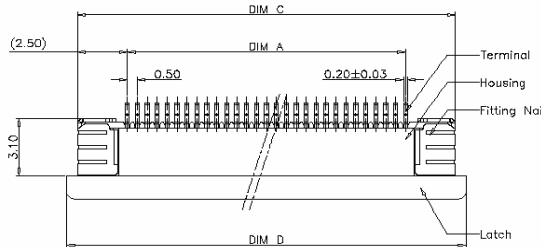

Note:
 1.Material:
 Housing:Thermoplastic High Temp.Ul94V-0;
 Color:Natural.
 Latch:Thermoplastic High Temp.Ul94V-0;
 Color:Black.
 Terminal: Copper Alloy.
 Fitting Nail:Copper Alloy.
 2.Finish:
 Terminal: Tin/Gold Flash overall.
 Fitting Nail: Tin overall.
 3.Electrical Characteristics:
 Current rating: 0.4A AC/DC
 Voltage rating: 50V AC/DC
 Temperature range: -25° C~+85° C
 Withstand Voltage: 250V AC/Minute
 Contact Resistance: 40mΩ Max
 Insulation resistance: 500mΩ Min
 Relative Humidity: 90% max
 Δ-The terminal that is available

PGCOMMFGDFD P C P PATTPN LAYOUT

PGCOMMFGDFD GPC/GTC DIMENSION

CKTS	DIM A	DIM B	DIM C	DIM D	DIM E	DIM F
Δ 4	1.50	2.60	6.50	7.60		
Δ 5	2.00	3.10	7.00	8.10		
Δ 6	2.50	3.60	7.50	8.60		
7	3.00	4.10	8.00	9.10		
Δ 8	3.50	4.60	8.50	9.60		
Δ 9	4.00	5.10	9.00	10.10		
Δ 10	4.50	5.60	9.50	10.60		
Δ 11	5.00	6.10	10.00	11.10		
Δ 12	5.50	6.60	10.50	11.60		
Δ 13	6.00	7.10	11.00	12.10		
Δ 14	6.50	7.60	11.50	12.60		
Δ 15	7.00	8.10	12.00	13.10		
Δ 16	7.50	8.60	12.50	13.60		
17	8.00	9.10	13.00	14.10		
Δ 18	8.60	9.60	13.60	14.60		
19	9.00	10.10	14.00	15.10	5.20	6.45
Δ 20	9.50	10.60	14.50	15.60		
21	10.00	11.10	15.00	16.10		
Δ 22	10.50	11.60	15.60	16.60		
23	11.00	12.10	16.00	17.10		
Δ 24	11.50	12.60	16.60	17.60		
Δ 25	12.00	13.10	17.00	18.10		
Δ 26	12.50	13.60	17.60	18.60		
27	13.00	14.10	18.00	19.10		
Δ 28	13.50	14.60	18.60	19.60		
29	14.00	15.10	19.00	20.10		
Δ 30	14.50	15.60	19.60	20.60		
31	15.00	16.10	20.00	21.10		
Δ 32	15.50	16.60	20.60	21.60		
Δ 33	16.00	17.10	21.00	22.10		
Δ 34	16.50	17.60	21.60	22.60		

Δ 35	17.00	18.10	22.00	23.10		
Δ 36	17.50	18.60	22.50	23.60		
37	18.00	19.10	23.00	24.10		
38	18.50	19.60	23.50	24.60		
39	19.00	20.10	24.00	25.10		
Δ 40	19.50	20.60	24.50	25.60		
41	20.00	21.10	25.00	26.10		
42	20.50	21.60	25.50	26.60		
43	21.00	22.10	26.00	27.10		
44	21.50	22.60	26.50	27.60		
Δ 45	22.00	23.10	27.00	28.10		
Δ 46	22.50	23.60	27.50	28.60		
47	23.00	24.10	28.00	29.10		
48	23.50	24.60	28.50	29.60	5.75	7.00
49	24.00	25.10	29.00	30.10		
Δ 50	24.50	25.60	29.50	30.60		
51	25.00	26.10	30.00	31.10		
52	25.50	26.60	30.50	31.60		
53	26.00	27.10	31.00	32.10		
Δ 54	26.50	27.60	31.50	32.60		
55	27.00	28.10	32.00	33.10		
56	27.50	28.60	32.50	33.60		
57	28.00	29.10	33.00	34.10		
58	28.50	29.60	33.50	34.60		
59	29.00	30.10	34.00	35.10		
Δ						



EFC-PT24-S**V4*

Connection Style: Straight (Vertical) Type

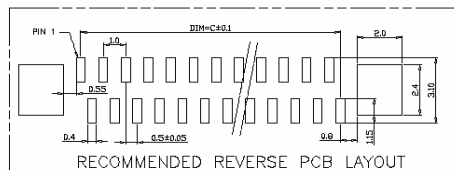
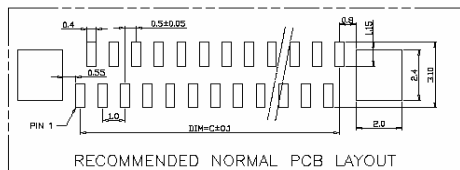
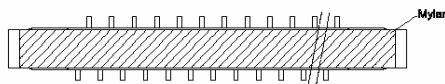
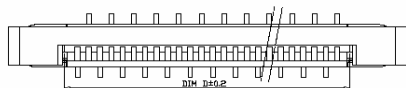
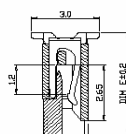
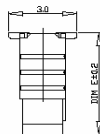
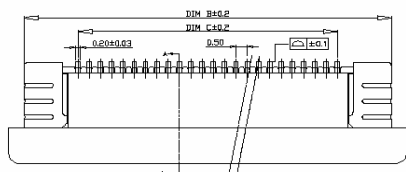
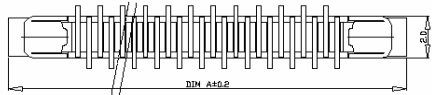

Electrical Characteristics:
 Current Rating: 0.4A AC/DC
 Voltage Rating: 50V AC/DC
 Operating Temperature: -25°C~+85°C
 Withstand Voltage: 200V AC/Minute
 Contact Resistance: 30mΩ max.
 Insulation Resistance: 500MΩ min.
 Operating Humidity: 93% max.

Material Description:
 Terminal: Phosphor Bronze
 Terminal Plating: Tin or Gold
 Solder Pad: Brass
 Housing: LCP (UL94V-0)
 Cover: LCP (UL94V-0)
 Mylar: PM

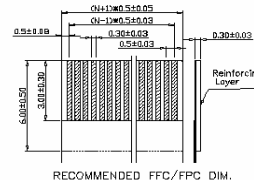

CKTS	DIM A	DIM B	DIM C	DIM D	DIM E
4	7.60	6.50	1.50	2.60	
5	8.10	7.00	2.00	3.10	
6	8.60	7.50	2.50	3.60	
7	9.10	8.00	3.00	4.10	
8	9.60	8.50	3.50	4.60	
9	10.10	9.00	4.00	5.10	
10	10.60	9.50	4.50	5.60	
11	11.10	10.00	5.00	6.10	
12	11.60	10.50	5.50	6.60	
13	12.10	11.00	6.00	7.10	
14	12.60	11.50	6.50	7.60	
15	13.10	12.00	7.00	8.10	
16	13.60	12.50	7.50	8.60	
17	14.10	13.00	8.00	9.10	
18	14.60	13.50	8.50	9.60	
19	15.10	14.00	9.00	10.10	
20	15.60	14.50	9.50	10.60	
21	16.10	15.00	10.00	11.10	
22	16.60	15.50	10.50	11.60	
23	17.10	16.00	11.00	12.10	
24	17.60	16.50	11.50	12.60	
25	18.10	17.00	12.00	13.10	
26	18.60	17.50	12.50	13.60	
27	19.10	18.00	13.00	14.10	
28	19.60	18.50	13.50	14.60	
29	20.10	19.00	14.00	15.10	
30	20.60	19.50	14.50	15.60	
31	21.10	20.00	15.00	16.10	
32	21.60	20.50	15.50	16.60	
33	22.10	21.00	16.00	17.10	
34	22.60	21.50	16.50	17.60	
35	23.10	22.00	17.00	18.10	

4.4

36	23.60	22.50	17.50	18.60	
37	24.10	23.00	18.00	19.10	
38	24.60	23.50	18.50	19.60	
39	25.10	24.00	19.00	20.10	
40	25.60	24.50	19.50	20.60	
41	26.10	25.00	20.00	21.10	
42	26.60	25.50	20.50	21.60	
43	27.10	26.00	21.00	22.10	
44	27.60	26.50	21.50	22.60	
45	28.10	27.00	22.00	23.10	
46	28.60	27.50	22.50	23.60	
47	29.10	28.00	23.00	24.10	
48	29.60	28.50	23.50	24.60	
49	30.10	29.00	24.00	25.10	
50	30.60	29.50	24.50	25.60	
51	31.10	30.00	25.00	26.10	
52	31.60	30.50	25.50	26.60	
53	32.10	31.00	26.00	27.10	
54	32.60	31.50	26.50	27.60	
55	33.10	32.00	27.00	28.10	
56	33.60	32.50	27.50	28.60	
57	34.10	33.00	28.00	29.10	
58	34.60	33.50	28.50	29.60	
59	35.10	34.00	29.00	30.10	
60	35.60	34.50	29.50	30.60	

4.9